

● LED Strobe Light for firefighting

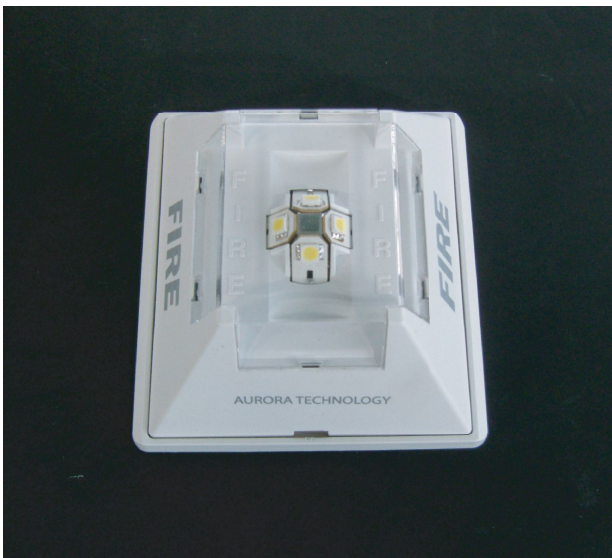

● Specifications



- Color : Red / White ABS Resin
- Current Consumption : 24 VDC / 70 mA
- Power Supply : 24 VDC (Non-Polar)
- Uses : IP67 Type (Industrial, Outdoor)  
Normal Type (Indoor)
- Dimension : 105 x 112 x 48
- Legal Regulations  
The United States in 1992, Korea in 1998 Visual Notification Appliance for the deaf shall be installed.

| Model       | Dimension<br>W x H x T (mm) | Type         | Current<br>Consumption | Illumination<br>(cd) | Color |
|-------------|-----------------------------|--------------|------------------------|----------------------|-------|
| E100-A1-01R | 105 x 112 x 48              | LED / 24 VDC | 70mA ± 20%             | 20                   | Red   |
| E100-A1-01W | 105 x 112 x 48              | LED / 24 VDC | 70mA ± 20%             | 20                   | White |

● **Dimension**

. Order No. (Normal Products)  
E100-A1-01x

└ R : Red  
W : White

. Materials : ABS Resin  
. Uses : Indoor

. Order No. (Waterproof Products)  
E100-A1-01x - IP67

└ R : Red  
W : White

Materials : ABS Resin (Strobe Light)  
ABS Resin / PC (Housing)

. Uses : Outdoor

(Unit : mm)

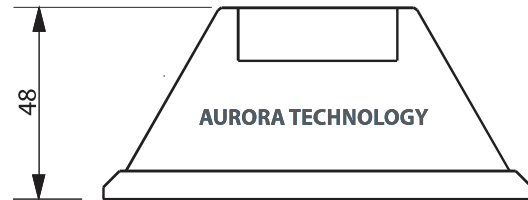
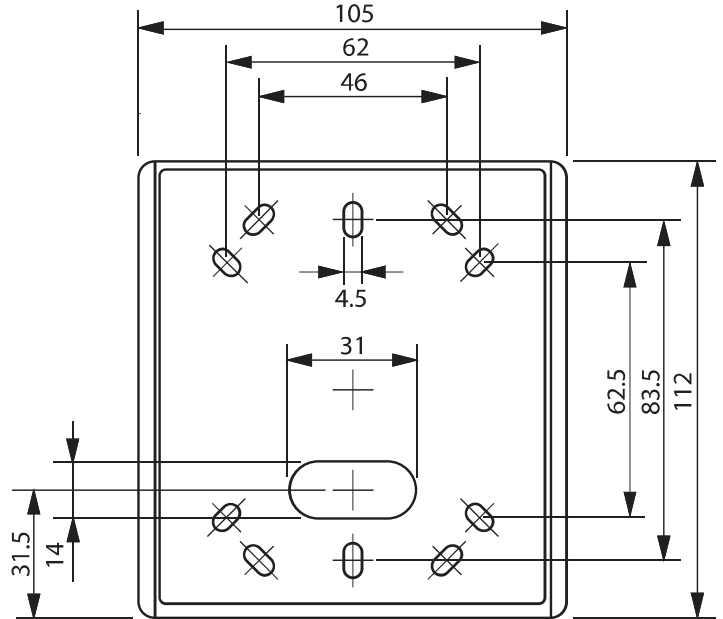

● **Specifications (Waterproof Strobe Light )**

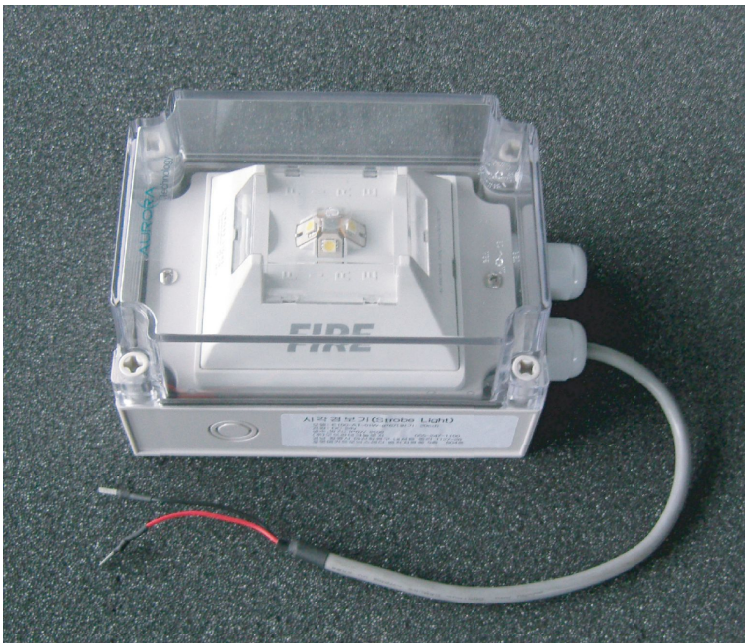

- Model : E100-A1-01W- IP67  
E100-A1-01R - IP67  
125(W) x 173(L) x 100(H)
- Strobe Light : E100 - A1 - 01R / W
  - Power supply : 24 VDC
  - Illumination : 20 cd
  - Lamp type : LED
- IP code : IP67 / IK08
- Uses : Underground tunnel etc  
Outdoor